

CERTIFIED RECORD OF LAND CORNER MONUMENTATION

History of original corner establishment:

Corner established by Samuel G. Caudle under contract #364, dated August 12, 1880.

Set post, for 1/4 Sec. cor., from which
 a cedar, 48 ins. diam., bears S5°W, 45 lks.
 a fir, 50 ins. diam., bears S38°E, 50 lks.

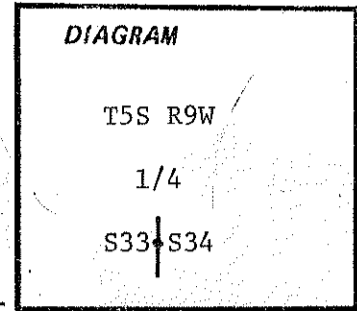

M. Whitmore, Tillamook Co. Deputy Surveyor, 1958, found the above-mentioned BT's with all scribe marks gone. The S.W. cedar was lying upon the ground.

He also found a 20" alder, N50°W, 6 ft. with scribe marks "1/4S CSBT" previously marked by the County surveyor, R.L.S. 259.

He set a pipe and marked additionally a 22" alder, N47°E, 20-1/2 ft. scribed "1/4S34BT." L. Whitmore believes distances to alders to be measured to the face of the BT.

Description of corner evidence found:

M. Whitmore's pipe was not found.
 Post 4" diam., 4 ft. long.
 30" alder BT, N50°W, 7.6 ft., no visible scribing set by County Surveyor.
 30" alder BT, N47°E, 19.3 ft., scribing visible 1/4 S34 T.
 Distances to BT's were measured to the side center.

Description of monument and accessories established to perpetuate the original location of this corner:

Set a 30"x3" diam. aluminum cap 6 ins. above the ground MKD. Aluminum cap has a magnet in the top and base with a break-away base.

4 ft. post is lying on the ground beside the cap.

Set a 6 ft. fence post with an attention sign and property boundary sign 1-ft. north of cap.

L. Whitmore scribed a 10" fir, N60°W, 16.5 ft. "1/4S33CS BT"

Painted a 6" band of red paint around all BT's

Nailed attention signs to the back side of all BT's

Posted BT tags on all BT's

Witnesses by L. Whitmore, Tillamook Co. Deputy Surveyor
 F. Wratni L.S.I.T. #209

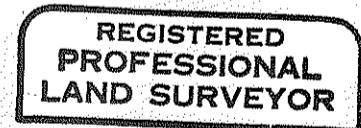
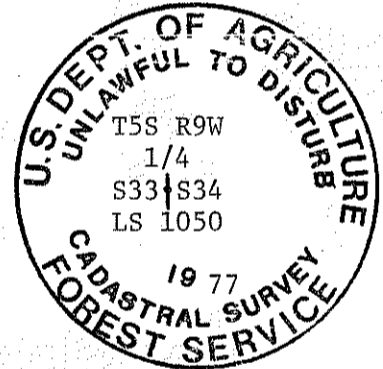

L. W. Hunnemuller

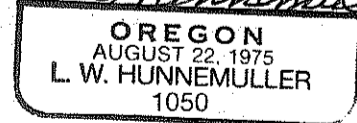

Office of County Surveyor County of Tillamook
 State of OREGON I hereby certify that the within instrument was filed in this office
 for record on the 14 day of AUGUST, 1977
J. H. Cantin COUNTY SURVEYOR
 (COUNTY OFFICIAL) (DEPUTY)